

# METEOR-K PLUS MANUAL

Read this manual carefully before using and keep for future reference. Visit [www.moon-sport.com](http://www.moon-sport.com) for manual updates.

## FEATURES

- Flat beam
- 1 CREE XP-G2 high brightness LED
- CNC Aluminium heat sink light cap
- Dimming system
- Mode memory function
- Day flash mode
- 2 steady modes, 3 flashing modes, SOS mode
- Quick release rechargeable lithium ion battery (3,7V 1400 mAh)
- Quick release universal bracket (fits all round and AERO style bars)
- Mode indicator
- Low battery, charging and fully charged indicator
- Automatic fully charged cut-off system
- Side visibility
- Water resistant (IPX 4)
- ANSI/FL1 Standards

## CONTENTS

METEOR-K PLUS  
RB-25 (Handlebar bracket)  
USB-WP (Water resistant USB cable)  
LX-BAT-1400 (Lithium ion battery 1400 mAh)

## OPTIONAL ACCESSORIES

RB-16 (Helmet bracket)  
RB-26 (Handlebar bracket)  
RB-28 (GoPro mount adapter)  
USB-RM-350 (USB remote control 350 mm)  
XP-USC (Wall charger)

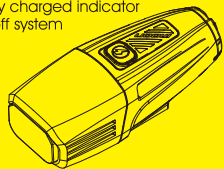

## OPERATION

1. Press power button to turn on the light.
  2. Press power button to choose modes.
  3. Double click power button to toggle between steady and flashing modes.
  4. Press and hold the power button for 1 second to turn off.
- \* With Mode Memory Function: the light resumes previous mode upon next usage.
- \* Remote switch operation is same as above.

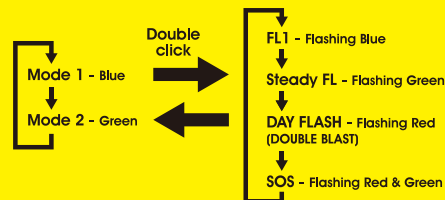
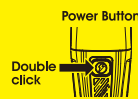

⚠ Use the SOS sign for real emergency only!

## DIMMING SYSTEM

Dimming system allows user to personalize the light output from the lowest to the highest. All modes are dimmable except the SOS mode.

1. Select a mode.
2. Long press power button to adjust the light output. The light flashes once when reaching the Max/Min light output.
3. Release power button when reach desired light output.

## RESTORE DEFAULT SETTINGS

Release the battery then press power button once to restore default settings.

## RUNTIME-DEFAULT

	MODE 1	MODE 2	FL 1	STEADY FL*	DAY FL	SOS
	350 LUMENS	150 LUMENS	100 LUMENS	400/20 LUMENS	400 LUMENS	80 LUMENS
	2:00 h : min	6:00 h : min	35:00 h : min	15:00 h : min	60:00 h : min	28:00 h : min

## RUNTIME-DIMMING

	MODE 1	MODE 2	FL 1	STEADY FL*	DAY FL	SOS
	350-20 LUMENS	350-20 LUMENS	400-20 LUMENS	400-20 / 20 LUMENS	400-20 LUMENS	80 LUMENS
	2:00 - 20:00 h : min	2:00 - 20:00 h : min	6:00 - 100:00 h : min	15:00 - 25:00 h : min	60:00 - 150:00 h : min	28:00 h : min

\* Steady FL is a steady-flashing mode. High lumen flashing plus low lumen steady beam for safety purpose. When using dimming function, only flashing output can be set. Steady output is fixed.

## HANDLEBAR MOUNTING

1. Install the bracket onto handlebar by wrapping rubber strap around bar and stretching strap around hook to secure.
2. Slide headlight forward onto bracket until it clicks into place.
3. Press down release lever to remove.

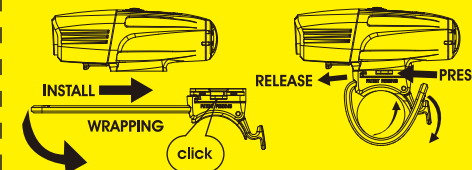

## HELMET MOUNTING (Optional)

1. Wrap belt around helmet and return the belt onto slotted space.
2. Twist screw knob clockwise until tight.
3. Slide headlight forward onto bracket until it clicks into place.
4. Press down release lever to remove.
5. To adjust the vertical beam angle when mounted on the helmet, loosen the screw knob and rotate the light up or down to your preferred angle, then tighten the screw knob to secure the light in.

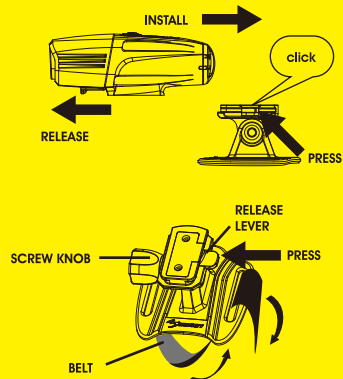

## REMOTE SWITCH INSTALLATION (Optional)

1. Connect the remote switch by using the usb port.
2. Put one end of the belt go through the cycle handlebar.
3. Align to the controller button and pass through.
4. Please pull the Velcro ends tightly.

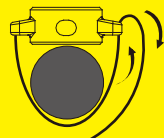

## BATTERY CAPACITY AND CHARGING INDICATOR

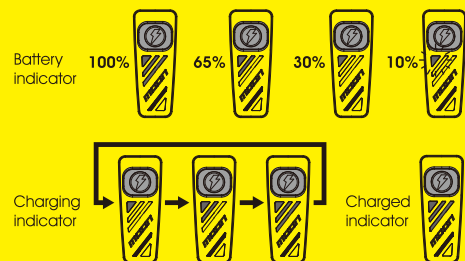

## BATTERY CHARGING AND CARE

1. Turn off the light.
2. Lift the rubber cover.
3. Plug the USB cable into charging port.
4. Plug the USB cable to wall or computer USB socket.
5. Charging Indicator will be on. Unplug the cable after fully charged.

## BATTERY INSTALLATION

1. Align the battery cover to the point "O" to open.
2. Release or insert battery.
3. Cover the battery with the battery cover.
4. Align the battery cover to the point "L" to lock.

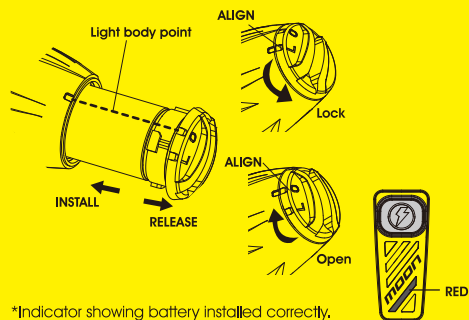

\*Indicator showing battery installed correctly.

## BATTERY CARE

- \* Do not charge over 5V, the battery will result in damage.
- \* Keep away from flammable objects while charging as this may lead to fire or battery explosion.
- \* Battery may get high temperatures during charging (up to 104°F/40°C).
- \* The battery capacity may become ineffective about 80% of its value after 300 charge/discharge cycles.
- \* The battery voltage and capacity decrease apparently at low temperatures, especially near or below ice point. The capacity decreases 5%-10% at freezing (burn time decreases 50%). At -20°C, the capacity decreases 30% (burn time decreases 70%). The battery performance will return normal when the temperature gets up to 70°F/20°C.
- \* Keep the battery in cool and dry place when storing. Recharge the battery fully at least every 3 months.

## ⚠ Warning

- \* Understand country lighting laws and regulations before use.
- \* Do not shine directly in the eyes.
- \* Light may get hot when in use.
- \* Adjust the angle downward to prevent from blinding the oncoming vehicles on the public roads.
- \* Do not submerge the battery or the whole light into water.
- \* Unplug the light once the battery is fully charged.
- \* Do not dismantle the light which will void warranty.
- \* Do not leave the light on and unattended.
- \* Keep the light away from fire and combustible materials.
- \* Do not store head unit when hot or straightway after use.
- \* Release the battery before storage to prevent light turning on.

## Warranty

MOON Lights are covered by a ONE YEAR LIMITED WARRANTY from the date of purchase is free from defects in material and workmanship. This warranty does not apply to damage due to heat, physical damage resulting from abuse, neglect, improper repair, improper fit, or alterations of the fixture. This covers the lights and cables only. Batteries are covered by 120 days warranty not including battery normal wear.

All customers should contact the local dealer or regional distributor for warranty service. To make a claim, first contact original dealer or distributor. Some issues may be resolved upon the initial call. If return of the product is necessary, use traceable method such as FedEx or UPS. MOON is not responsible for lost or misdirected packages.

Please include your full contact information (name, address, phone number, and email [if applicable]) and a description of the issue.

For more information please contact us at [cs@moon-sport.com](mailto:cs@moon-sport.com)

## ONLINE WARRANTY REGISTRATION

Visit the following link for online warranty registration:  
[www.moon-sports.com/warranty](http://www.moon-sports.com/warranty)