

# CERBERUS LINK MANUAL

The light is locked for shipment, after to OPERATION instruction to unlock. Read this manual carefully before using and keep for future reference. Visit [www.moon-sport.com](http://www.moon-sport.com) for manual updates.

## CONTENTS

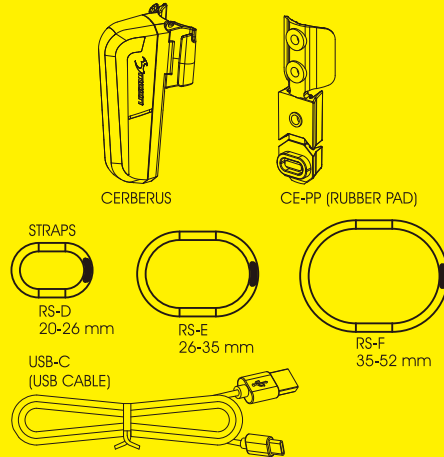

## OPERATION



- ON / OFF : Press 1s
- MODE SELECT : Click
- STEADY / FLASH : Double Click
- LOCK/UNLOCK : 1. Power off  
2. Press 8s: Locked   
Unlocked:

- \* Lock system: Lock the light to prevent accidentally turned on.
- \* Mode memory: The light resumes previous mode upon next usage.

## VARIABLE LUMEN SYSTEM

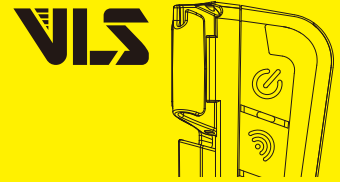

- Select desired mode.
- Press and hold to set lumen.
- Release when reaching desired lumen.

\* Light flashes once when reaching the MAX or MIN lumen level.

\* Restore default mode: Press + → →

## WIRELESS CONNECTION

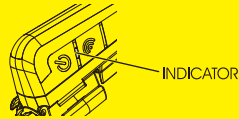

- Restore default setting of headlight and taillight, Press + 5s (\*May connect up to 5 taillights)
- Wireless connection will be connected automatically.

### OPERATION

All connected taillights are operated simultaneously.

- ON / OFF : Press 1s
- MODE SELECT : Click
- STEADY / FLASH : Double Click
- VLS : Press and hold to set lumen.

### INDICATOR - CONNECTION

Connecting Connected

For power saving purpose (to pause the wireless connecting signal), make sure to lock the light when not in use or after charging.

## RUNTIME

	ANSI FL1	MODE1	MODE2	FLASH	STEADY FLASH	DAY FLASH
DEFAULT LUMEN	LUMEN	25	50	25	25	150
H-MIN	H-MIN	2:30	1:30	12:00	9:00	15:00
VLS LUMEN	VLS LUMEN	50-5	50-5	100-10	100-10	150-10
H-MIN	H-MIN	1:30-13:00	1:30-13:00	3:30-32:00	5:30-15:00	15:00-50:00

## AUTO SAFE MODE



To preserve battery when power is low, the light will enter safe mode with less light output for extra **45mins**. Safe mode cannot be override. Recharge battery for maximum performance.

## MOUNTING

### RUBBER PAD INSTALLATION

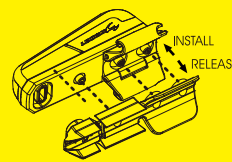

### SEATPOST MOUNTING

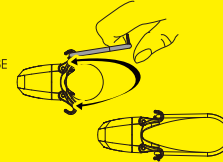

## CHARGING

- Power off
- Plug USB cable to USB port
- Unplug after fully charged

- \* Do not charge over 5V.
- \* Keep away from flammable objects while charging.

### INDICATOR

Low battery Auto safe Charging Fully Charged

## WARNING

Understand country lighting laws and regulations before use. Do not shine light directly into eyes. Do not mount near wireless computer. Do not blind the oncoming vehicles. Always adjust the angle downward. Do not submerge the light into water. Keep light in cool and dry place when storing. Fully recharge the light at least every 3 months during storage.

## WARRANTY

MOON lights are covered by a ONE YEAR LIMITED WARRANTY while MOON batteries are covered by 120 days warranty from the date of purchase. This warranty covers the defects in material and workmanship only with proof of purchase. Please contact original dealer for warranty service. For lights bought on MOON website, please contact [cs@moon-sport.com](mailto:cs@moon-sport.com) for help.

### ONLINE WARRANTY REGISTRATION

Visit [www.moon-sport.com](http://www.moon-sport.com) for online warranty registration.