



The light is locked for shipment, refer to OPERATION instruction to unlock. Read this manual carefully before using and keep for future reference. Visit www.moon-sport.com for manual updates.



METEOR VORTEX MANUAL

CONTENTS

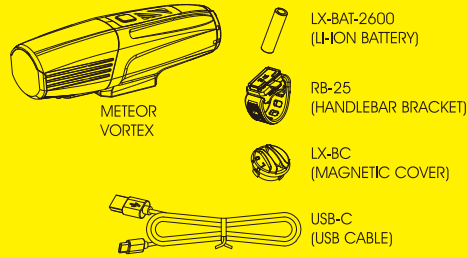

Optional accessories:
 RB-28 (GoPro mount adapter)
 LX-BAT-3350 (Lithium ion battery 3350 mAh)
 RB-16 (Helmet Bracket)

OPERATION



ON / OFF : Press 1s
 MODE SELECT : Click
 BOOST MODE : Double click
 LOCK/UNLOCK : 1. Power off
 2. Press 6s: Locked Unlocked
 Flash 1 time Flash 2 times

* Lock system: Lock the light to prevent accidentally turned on.
 * Mode memory: The light resumes previous mode upon next usage.

MODE INDICATOR



MODES



Boost Blue



Mode 1 Blue



Mode 2 Green



Flash 1 Flashing Blue



Steady FL Flashing Green



DAY FL Flashing Red



S.O.S. Flashing Red & Green

VARIABLE LUMEN SYSTEM



1. Select desired mode.
2. Press and hold to set lumen.
3. Release when reaching desired lumen.

* Light flashes once when reaching the MAX or MIN lumen level.

* Restore default setting: Release battery and click

* Mode memory: The light resumes previous VLS setting upon next usage.

RUNTIME

| DEFAULT LUMEN | BOOST | MODE1 | MODE2 | FLASH1 | STEADY FLASH | DAY FLASH | SOS |
|---------------------|-------|------------|------------|--------------|--------------|--------------|-------|
| | 1000 | 700 | 100 | 100 | 200 | 400 | 40 |
| | 1:45 | 3:00 | 14:00 | 70:00 | 30:00 | 61:00 | 87:00 |
| VLS LUMEN | - | 700-20 | 700-20 | 700-20 | 700-20 | 700-20 | - |
| | - | 3:00-70:00 | 3:00-70:00 | 10:00-240:00 | 15:00-50:00 | 59:00-300:00 | - |

* Steady Flash Mode: High lumen flashing plus low lumen steady beam for safety purpose.

Use the SOS sign for real emergency only!

HANDLEBAR MOUNTING

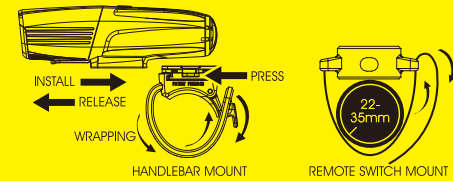

HELMET MOUNT(Optional)

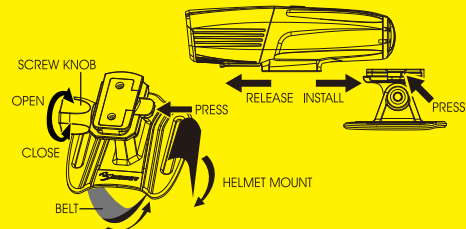

OVERHEAT PROTECTION

The overheat protection device can ensure the bicycle light in a good running temperature condition, so that to protect the LEDs without burning case. If the light is in high temperature during operation, it will dim the light output.

CHARGING

1. Power off.
2. Plug USB cable to USB port.
3. Unplug after fully charged.

* Do not charge over 5V.
 * Keep away from flammable objects while charging.



BATTERY INSTALLATION

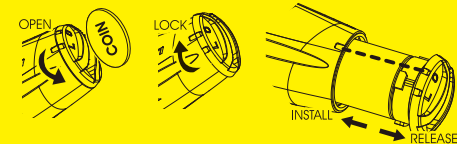

BATTERY CAPACITY AND CHARGING INDICATOR

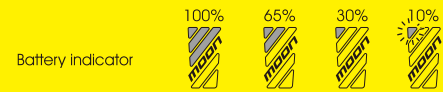

Battery indicator



Charging indicator

Charged indicator

Battery installed indicator

WARNING

Understand country lighting laws and regulations before use.
 Do not shine light directly into eyes.
 Do not mount near wireless computer.
 Do not blind the oncoming vehicles. Always adjust the angle downward.
 Do not submerge the light into water.
 Keep light in cool and dry place when storing.
 Fully recharge the light at least every 3 months during storage.

WARRANTY

MOON lights are covered by a ONE YEAR LIMITED WARRANTY while MOON batteries are covered by 120 days warranty from the date of purchase. This warranty covers the defects in material and workmanship only with proof of purchase. Please contact original dealer for warranty service. For lights bought on MOON website, please contact cs@moon-sport.com for help.

ONLINE WARRANTY REGISTRATION
 Visit www.moon-sport.com for online warranty registration.