

METEOR-X AUTO PRO

MANUAL



Read this manual carefully before using and refer for future reference. Visit www.moon-sport.com for manual updates.

FEATURES

- 1 high brightness LED
- CNC Aluminium heat sink light cap
- Light sensitive auto on/off
- Mode memory function
- Day flash mode
- 3 steady modes, 3 flashing modes, SOS mode
- Quick release rechargeable lithium ion battery (3.7V 1600 mAh)
- Quick release universal bracket (fits all round and AERO style bars)
- Low battery, charging and fully charged indicator
- Automatic fully charged cut-off system
- High precision optical lens
- Side visibility
- Recharge time 2,5hrs
- Water resistant (IPX 4)

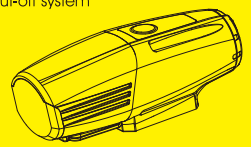

CONTENTS

- METEOR-X AUTO PRO
- RB-25 (Handlebar bracket)
- USB-WP (Water resistant USB cable)
- LX-BAT-1600 (Lithium ion battery 1600 mAh)

Optional accessories:

- RB-16 (Helmet bracket)
- RB-26 (Handlebar bracket)
- RB-28 (GoPro mount adapter)
- USB-RM-350 (USB remote control 350 mm)
- XP-USC (Wall charger)

OPERATION

1. Press power button to turn on the light,
 2. Press power button to choose modes,
 3. Double click power button to toggle between steady and flashing modes,
 4. Press power button for 1 sec to turn off the light,
- * With Mode Memory Function:
the light resumes previous mode upon next usage,
* Remote switch operation is same as above,

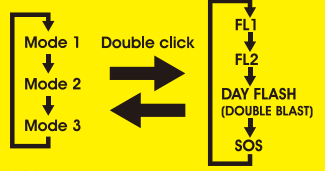
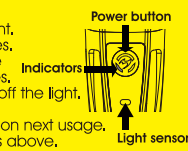

▲ Use the SOS sign for real emergency only!

LIGHT SENSITIVE AUTO ON/OFF OPERATION

1. Press power button to turn on light,
 2. To turn on the light sensitive function, press and hold the power button for 3 seconds until indicator turns green,
 3. Select the mode you want to use by pressing the power button
 4. Press the power button for 1 second to switch off,
 5. To turn off light sensitive function, press and hold power button 3 seconds until indicator turns blue,
- * Sensor has a 30 seconds delay when in well-lit environment before light turns off.
▲ Turn off the light sensitive function before storing!

OVERHEAT PROTECTION

The overheat protection device can ensure the bicycle light in a good running temperature condition, so that to protect the LEDs without burning case. If the light is in high temperature during operation, it will dim the light output,

RUNTIME

	Mode1	Mode2	Mode3	FL1	FL2	DAY FL	SOS
LUMEN	600	300	150	100	300	700	-
H:MIN	2:00	3:30	6:15	56:00	18:00	57:00	32:00
1M LUX	4310	2370	1220	/	/	/	/
2M LUX	1030	550	310	/	/	/	/
10M LUX	43	24	13	/	/	/	/



HANDLEBAR MOUNTING

1. Install the bracket onto handlebar by wrapping rubber strap around post/bar and stretching strap around hook to secure,
2. Slide headlight forward onto bracket until it clicks into place,
3. Press down release lever to remove,

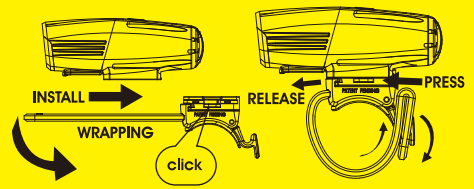

REMOTE SWITCH INSTALLATION (Optional)

1. Connect the remote switch by using the usb port,
2. Put one end of the belt go through the cycle handlebar,
3. Align to the controller button and pass through,
4. Please pull the Velcro ends tightly,

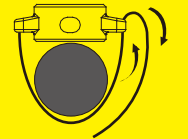

HELMET MOUNTING (Optional)

1. Wrap belt around helmet and return the belt onto slotted space,
2. Twist screw knob clockwise until tight,
3. Slide headlight forward onto bracket until it clicks into place,
4. Press down release lever to remove,
5. To adjust the vertical beam angle when mounted on the helmet, loosen the screw knob and rotate the light up or down to your preferred angle, then tighten the screw knob to secure the light in.

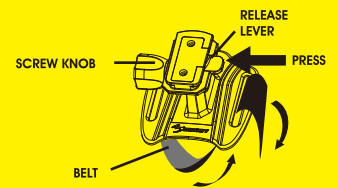
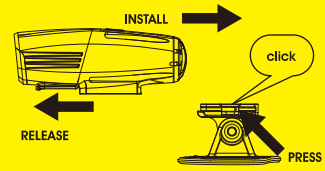

BATTERY CAPACITY AND CHARGING INDICATOR

Normal status
● * Working - steady blue

Light sensor status
● * Standby - flashing green
● * Working - steady green

Low battery status
● * Steady red

Charging indicator
● * Flashing Blue - charging
● * Steady Blue - charged

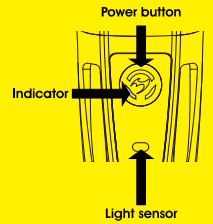

BATTERY CHARGING AND CARE

1. Turn off the light,
2. Lift the rubber cover,
3. Plug the USB cable into charging port,
4. Plug the USB cable to wall or computer USB socket,
5. Charging indicator will be on, Unplug the cable after fully charged,

BATTERY INSTALLATION

1. Align the battery cover to the point "O" to open,
2. Release or insert battery,
3. Cover the battery with the battery cover,
4. Align the battery cover to the point "L" to lock,

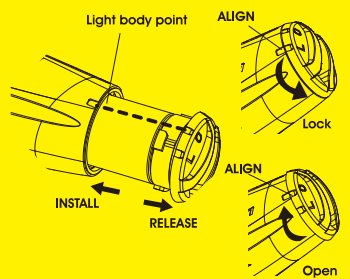

BATTERY CARE

- * Do not charge over 5V, the battery will result in damage,
- * Keep away from flammable objects while charging as this may lead to fire or battery explosion,
- * Battery may get high temperatures during charging (up to 104°F/40°C),
- * After 300 charge/discharge, the battery capacity may drop to around 80%,
- * The battery voltage and capacity decrease apparently at low temperatures, especially near or below ice point, The capacity decreases 5%-10% at freezing (burn time decreases 50%), At -20°C, the capacity decreases 30% (burn time decreases 70%), The battery performance will return normal when the temperature gets up to 70°F/20°C,
- * Keep the battery in cool and dry place when storing, Recharge the battery fully at least every 3 months,

Warning

- * Understand country lighting laws and regulations before use,
- * Do not shine directly in the eyes,
- * Light may get hot when in use,
- * Adjust the angle downward to prevent from blinding the oncoming vehicles on the public roads,
- * Do not submerge the battery or the whole light into water,
- * Unplug the light once the battery is fully charged,
- * Do not dismantle the light which will void warranty,
- * Do not leave the light on and unattended,
- * Keep the light away from fire and combustible materials,
- * Do not store head unit when hot or straightway after use,
- * Release the battery before storage to prevent light turning on,

Warranty

MOON Lights are covered by a ONE YEAR LIMITED WARRANTY from the date of purchase is free from defects in material and workmanship. This warranty does not apply to damage due to heat, physical damage resulting from abuse, neglect, improper repair, improper fit, or alterations of the fixture. This covers the lights and cables only. Batteries are covered by 120 days warranty not including battery normal wear.

All customers should contact the local dealer or regional distributor for warranty service. To make a claim, first contact original dealer or distributor. Some issues may be resolved upon the initial call. If return of the product is necessary, use traceable method such as FedEx or UPS, MOON is not responsible for lost or misdirected packages.

Please include your full contact information (name, address, phone number, and email [if applicable]) and a description of the issue.

For more information please contact us at cs@moon-sport.com

ONLINE WARRANTY REGISTRATION
Visit www.moon-sport.com for online warranty registration.